

CORNER RECORD

Agency Index CR22-045

Document Number 011-273-18 (ADJ)

City of SAN RAFAEL County of MARIN, California

Brief Legal Description MONUMENT LOCATED WITHIN THIRD STREET AT 810 THIRD STREET

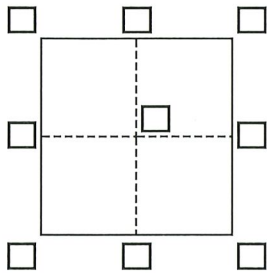

CORNER TYPE

Government Corner Control
 Meander Property
 Rancho Other

Date of Survey January - February 2022

COORDINATES (Optional)

N. _____ E. _____

Elevation _____

Units Metric U.S. Survey Foot

Horizontal Datum _____

Zone _____ Epoch Date _____

Vertical Datum _____

Complies with Public Resources Code §§8801-8819
 Complies with Public Resources Code §§8890-8902

PLS Act Ref.: 8765(d) 8771 8773 Other:

Corner/Monument: Left as found Established Rebuilt Pre-Construction
 Found and tagged Reestablished Referenced Post-Construction

Narrative of corner identified and monument as found, set, reset, replaced, or removed:

See sheet #2 for description(s):

FOUND NAIL AND TAG, SET IN SIDEWALK, WITHIN THIRD STREET AT 810 THIRD STREET, LABELED LS 2535, PER 1998 M 58.
 SET REFERENCE POINTS IN CONCRETE AND ASPHALT AS SHOWN ON PAGE 2 TO PRESERVE MONUMENT LOCATION.

SURVEYOR'S STATEMENT

This Corner Record was prepared by me or under my direction in conformance with

the Professional Land Surveyors' Act on May 10, 2022

Signed [Signature] P.L.S. or R.C.E. No. 9387



COUNTY SURVEYOR'S STATEMENT

This Corner Record was received 8/4/22

and examined and filed 9/19/22

Signed [Signature] P.L.S. or R.C.E. No. 8176

Title County Surveyor

County Surveyor's Comment



Graphic Scale (in feet)



1 inch = 30 ft.

DOC# 011-273-18 (ADJ)
AGENCY INDEX: CR22-045

LANDS OF KOTOFF
APN: 011-273-18
810 3RD ST, SAN RAFAEL, CA
94901



SET NAIL AND
TAG PLS 9387
IN CONCRETE

SET NAIL AND
TAG PLS 9387
IN CONCRETE

**3RD STREET (WESTBOUND -
ONE WAY DIRECTION)**

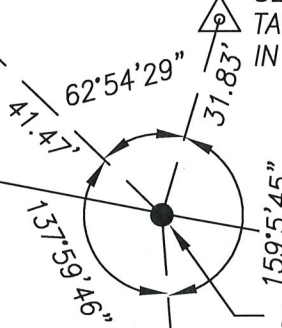

FOUND NAIL AND TAG
LS 2535 SET IN
SIDEWALK
PER 1998 M 58

SET NAIL AND
TAG PLS 9387
IN ASPHALT

LANDS OF CIGAP LLC
APN: 011-274-02
813 3RD ST, SAN RAFAEL, CA
94901

LANDS OF SMITHS
APN: 011-274-03
807 3RD ST, SAN RAFAEL, CA 94901

LEGEND

- TIE TO PRE-CONSTRUCTION REFERENCE POINT
- △ CONTROL POINT AS NOTED
- FOUND MONUMENT AS NOTED

CSW | ST2

CSW/Stuber-Stroeh Engineering Group, Inc.

Civil & Structural Engineers | Surveying & Mapping | Environmental Planning
Land Planning | Construction Management

45 Leveroni Court
Novato, CA 94949

tel: 415.883.9850
fax: 415.883.9835

http://www.cswst2.com

© 2019

Rev. -

Date: 05/10/22

Job No. 1920101.50

Scale: 1" = 30'

**MONUMENT PRESERVATION
CORNER RECORD**

MONUMENT LOCATED WITHIN 3RD STREET AT 810 3RD ST
SAN RAFAEL MARIN CALIFORNIA